

META CABLE DRUM RACKS

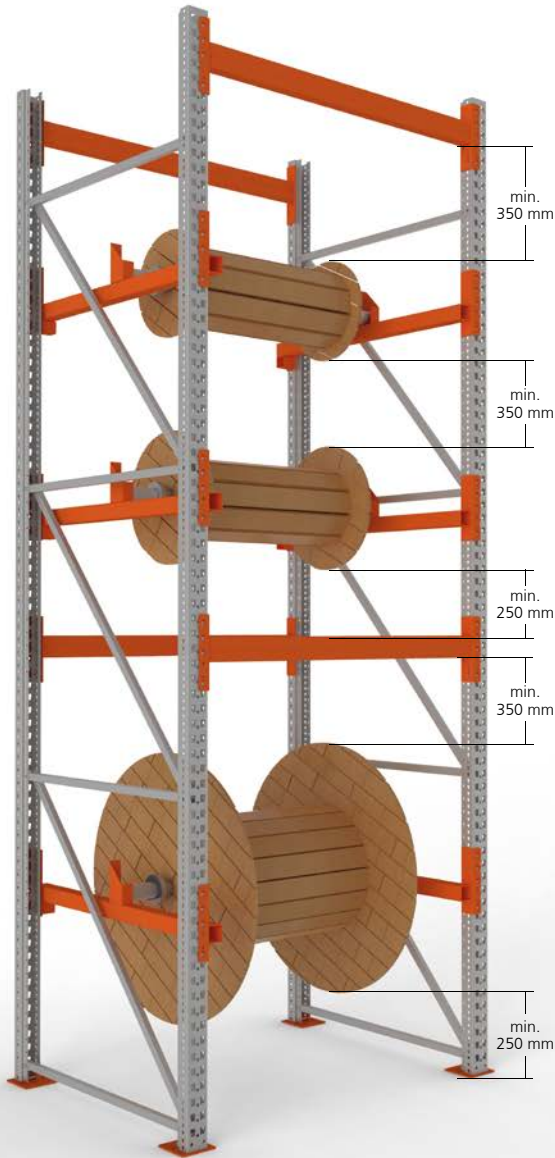

META MULTIPAL Cable Drum Rack Type 1

Order suggestions support type 1 for manual operation only



- META Cable Drum System is the basis for a clear and spacesaving storage of cable drums of a wide variety of designs.
- The screwed shelves can be flexibly adapted to the most diverse requirements.
- Subsequent additions and extensions are easily possible.
- Quick and easy to assemble system accessories.
- Stand heights from 2,200 to 5,500 mm
Stand depth 1,100 mm
Shelf widths of 900, 1,100, 1,300 mm
- Galvanized or plastic coated stand RAL 5010 gentian blue
Diagonal and horizontal galvanized
Tie bars RAL 2001 red orange
- The accessories such as tie bars, mounting parts for drum axle, including ground anchors, are completely included. The cable drum axis must be selected separately (see page 9).
- Designed for indoor installation only
- No earthquake zone considered
- With 2 tie bars – max. 4,000 kg for shelf height ≤ 3,000 mm (from 4 sections)
With 3 tie bars – max. 5,500 kg for shelf height ≤ 3,000 mm (from 4 sections)
- Intact drums/flawless cargo are assumed
- For assembly options with dimensions, see page 6

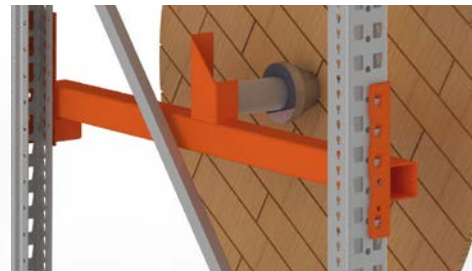

Plan dimensions:

Basic rack = nominal size + 170 mm
Add-on rack = nominal size + 85 mm
Total depth = frame depth

Support type 1
for manual operation only

Cable drum racks · incl. Cable drum support **Type 1** without cable drum axle

| Height mm | Section | | | Record Number of Axles | Section Load kg | Galvanized stand | | RAL 5010 gentian blue | |
|--------------|-------------|-------------|---|------------------------------|-----------------------|---|---|---|--|
| | Width mm | Depth mm | Basic Shelf Art. No. 402 6212 ... | | | Extension Shelf Art. No. 402 6212 ... | Basic Shelf Art. No. 402 6212 ... | Extension Shelf Art. No. 402 6212 ... | |
| 2,200 | 900 | 1,100 | 2 | 4,000 | ■ ... 393729 | ■ ... 393736 | ■ ... 143539 | ■ ... 143546 | |
| 2,200 | 1,100 | 1,100 | 2 | 4,000 | ■ ... 393750 | ■ ... 393767 | ■ ... 143553 | ■ ... 143560 | |
| 2,200 | 1,300 | 1,100 | 2 | 4,000 | ■ ... 393774 | ■ ... 393781 | ■ ... 143577 | ■ ... 143584 | |
| 2,700 | 900 | 1,100 | 2 | 4,000 | ■ ... 393798 | ■ ... 393804 | ■ ... 143591 | ■ ... 143607 | |
| 2,700 | 1,100 | 1,100 | 2 | 4,000 | ■ ... 393811 | ■ ... 393828 | ■ ... 143614 | ■ ... 143621 | |
| 2,700 | 1,300 | 1,100 | 2 | 4,000 | ■ ... 393835 | ■ ... 393842 | ■ ... 143638 | ■ ... 143645 | |
| 3,300 | 900 | 1,100 | 2 | 4,000 | ■ ... 393859 | ■ ... 393866 | ■ ... 143652 | ■ ... 143669 | |
| 3,300 | 1,100 | 1,100 | 2 | 4,000 | ■ ... 393873 | ■ ... 393880 | ■ ... 143676 | ■ ... 143683 | |
| 3,300 | 1,300 | 1,100 | 2 | 4,000 | ■ ... 393897 | ■ ... 393903 | ■ ... 143690 | ■ ... 143706 | |
| 3,800 | 900 | 1,100 | 2 | 4,000 | ■ ... 393941 | ■ ... 393958 | ■ ... 143713 | ■ ... 143720 | |
| 3,800 | 1,100 | 1,100 | 2 | 4,000 | ■ ... 393965 | ■ ... 393972 | ■ ... 143737 | ■ ... 143744 | |
| 3,800 | 1,300 | 1,100 | 2 | 4,000 | ■ ... 393989 | ■ ... 393996 | ■ ... 143751 | ■ ... 143768 | |
| 4,400 | 900 | 1,100 | 4 | 5,500 | ■ ... 394047 | ■ ... 394054 | ■ ... 143775 | ■ ... 143782 | |
| 4,400 | 1,100 | 1,100 | 4 | 5,500 | ■ ... 394061 | ■ ... 394078 | ■ ... 143799 | ■ ... 143805 | |
| 4,400 | 1,300 | 1,100 | 4 | 5,500 | ■ ... 394085 | ■ ... 394092 | ■ ... 143812 | ■ ... 143829 | |
| 5,500 | 900 | 1,100 | 4 | 5,500 | ■ ... 394122 | ■ ... 394139 | ■ ... 143836 | ■ ... 143843 | |
| 5,500 | 1,100 | 1,100 | 4 | 5,500 | ■ ... 394146 | ■ ... 394153 | ■ ... 143850 | ■ ... 143867 | |
| 5,500 | 1,300 | 1,100 | 4 | 5,500 | ■ ... 394160 | ■ ... 394177 | ■ ... 143874 | ■ ... 143881 | |

■ on request

META MULTIPAL Cable Drum Rack Type 1

Structural examples

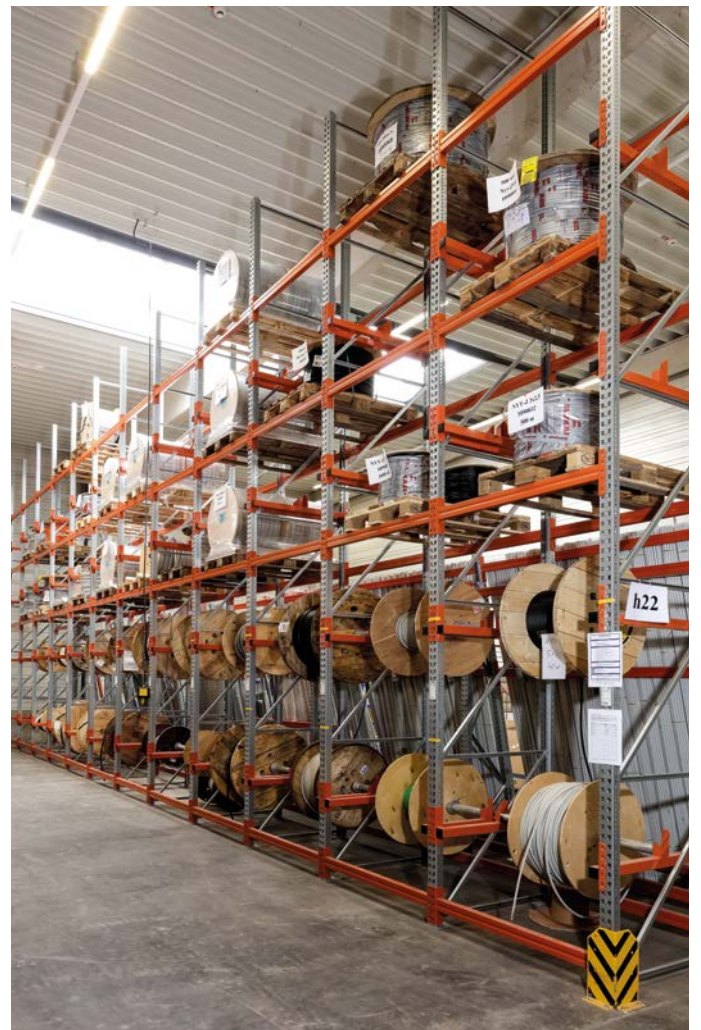

META MULTIPAL Cable Drum Rack Type 2

Order suggestions support type 2 suitable for manual processing



- DMETA Cable Drum System is the basis for a clear and spacesaving storage of cable drums of a wide variety of designs.
- The screwed shelves can be flexibly adapted to the most diverse requirements.
- Subsequent additions and extensions are easily possible.
- Quick and easy to assemble system accessories.
- Stand heights from 2,200 to 5,500 mm
Stand depth 1,100 mm
Shelf widths of 900, 1,100, 1,300 mm
- Galvanized or plastic coated stand RAL 5010 gentian blue
diagonal and horizontal galvanized
Tie bars RAL 2001, red orange
- The accessories such as tie bars, mounting parts for drum axle, including ground anchors, are completely included. The cable drum axis must be selected separately (see page 9).
- With 2 tie bars – max. 4,000 kg for shelf height ≤ 3,000 mm (from 4 sections)
With 3 tie bars – max. 5,500 kg for shelf height ≤ 3,000 mm (from 4 sections)
- Intact drums/flawless cargo are assumed
- For assembly options with dimensions, see page 6

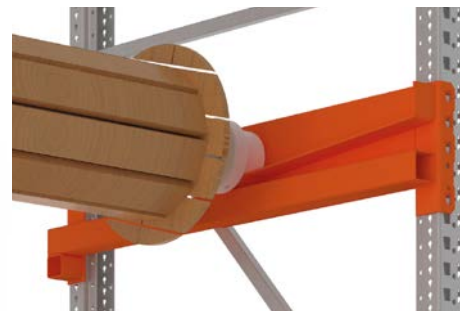

Plan dimensions:

Basic rack = nominal size + 170 mm
Add-on rack = nominal size + 85 mm
Total depth = frame depth

Support type 2
for manual operation only

Cable drum racks · incl. Cable drum support **Type 2** without cable drum axle

| Height mm | Section | | | Record Number of Axles | Section Load kg | Galvanized stand | | RAL 5010 gentian blue | |
|--------------|-------------|-------------|---|------------------------------|-----------------------|---|---|---|--|
| | Width mm | Depth mm | Basic Shelf Art. No. 402 6212 ... | | | Extension Shelf Art. No. 402 6212 ... | Basic Shelf Art. No. 402 6212 ... | Extension Shelf Art. No. 402 6212 ... | |
| 2,200 | 900 | 1100 | 2 | 4,000 | ■ ... 394221 | ■ ... 394238 | ■ ... 273076 | ■ ... 273083 | |
| 2,200 | 1,100 | 1100 | 2 | 4,000 | ■ ... 394245 | ■ ... 394252 | ■ ... 273090 | ■ ... 273106 | |
| 2,200 | 1300 | 1100 | 2 | 4,000 | ■ ... 394269 | ■ ... 394276 | ■ ... 273113 | ■ ... 273120 | |
| 2,700 | 900 | 1100 | 2 | 4,000 | ■ ... 394283 | ■ ... 394290 | ■ ... 273137 | ■ ... 273144 | |
| 2,700 | 1,100 | 1100 | 2 | 4,000 | ■ ... 394313 | ■ ... 394320 | ■ ... 273151 | ■ ... 273168 | |
| 2,700 | 1,300 | 1100 | 2 | 4,000 | ■ ... 394337 | ■ ... 394344 | ■ ... 273175 | ■ ... 273182 | |
| 3,300 | 900 | 1100 | 2 | 4,000 | ■ ... 394351 | ■ ... 394368 | ■ ... 272956 | ■ ... 272963 | |
| 3,300 | 1,100 | 1100 | 2 | 4,000 | ■ ... 394375 | ■ ... 394382 | ■ ... 272970 | ■ ... 272987 | |
| 3,300 | 1,300 | 1100 | 2 | 4,000 | ■ ... 394399 | ■ ... 394405 | ■ ... 272994 | ■ ... 273007 | |
| 3,800 | 900 | 1100 | 2 | 4,000 | ■ ... 394412 | ■ ... 394429 | ■ ... 273199 | ■ ... 273205 | |
| 3,800 | 1,100 | 1100 | 2 | 4,000 | ■ ... 394436 | ■ ... 394443 | ■ ... 273212 | ■ ... 273229 | |
| 3,800 | 1,300 | 1100 | 2 | 4,000 | ■ ... 394450 | ■ ... 394467 | ■ ... 273236 | ■ ... 273243 | |
| 4,400 | 900 | 1100 | 4 | 5,500 | ■ ... 394498 | ■ ... 394603 | ■ ... 273014 | ■ ... 273021 | |
| 4,400 | 1,100 | 1100 | 4 | 5,500 | ■ ... 394504 | ■ ... 394511 | ■ ... 273038 | ■ ... 273045 | |
| 4,400 | 1,300 | 1100 | 4 | 5,500 | ■ ... 394528 | ■ ... 394535 | ■ ... 273052 | ■ ... 273069 | |
| 5,500 | 900 | 1100 | 4 | 5,500 | ■ ... 394542 | ■ ... 394559 | ■ ... 273250 | ■ ... 273267 | |
| 5,500 | 1,100 | 1100 | 4 | 5,500 | ■ ... 394566 | ■ ... 394573 | ■ ... 273274 | ■ ... 273281 | |
| 5,500 | 1,300 | 1100 | 4 | 5,500 | ■ ... 394580 | ■ ... 394597 | ■ ... 273298 | ■ ... 273304 | |

■ on request

META MULTIPAL Cable Drum Rack Type 2

Structural examples

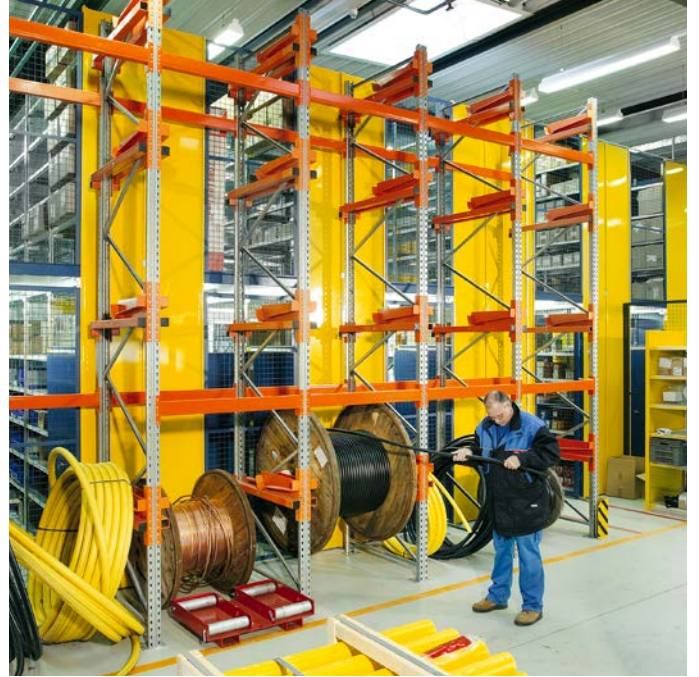

META MULTIPAL Cable Drum Rack Type 1 and Type 2

Structural examples

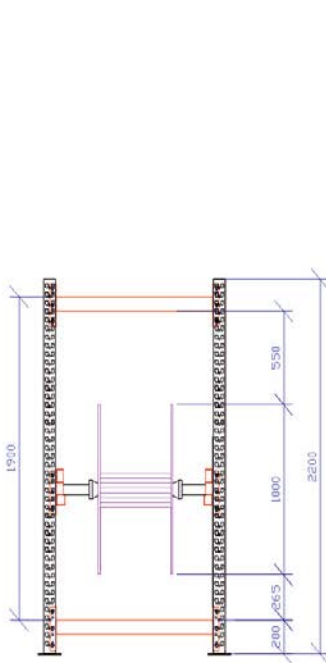

Height
2,200 mm

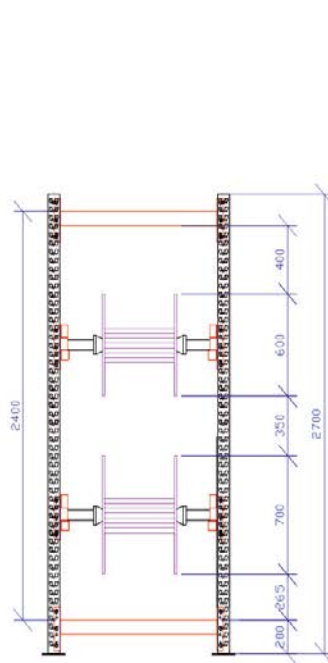

Height
2,700 mm

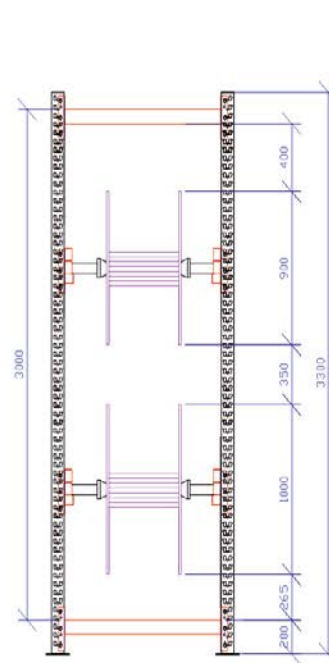

Height
3,300 mm

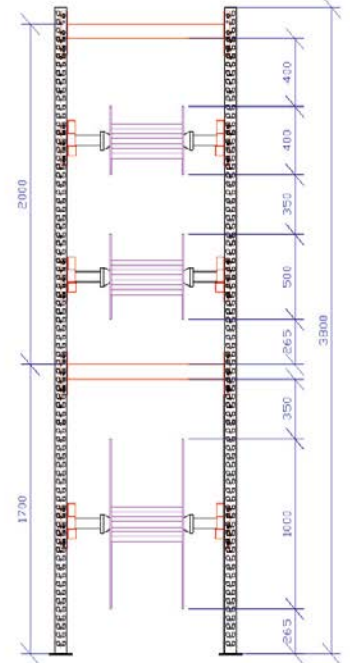

Height
3,800 mm

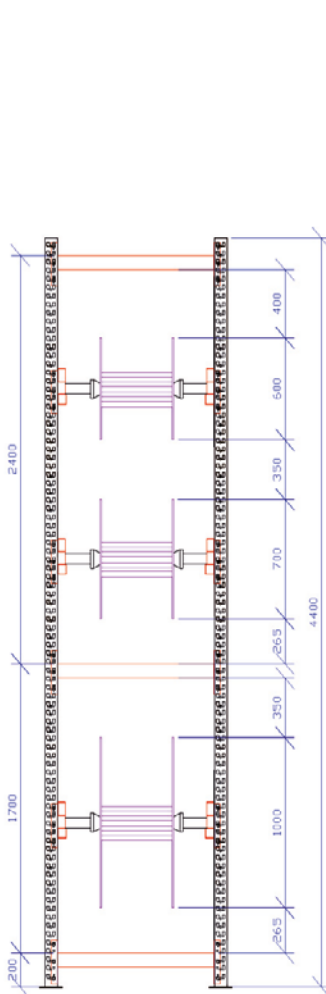

Height
4,400 mm

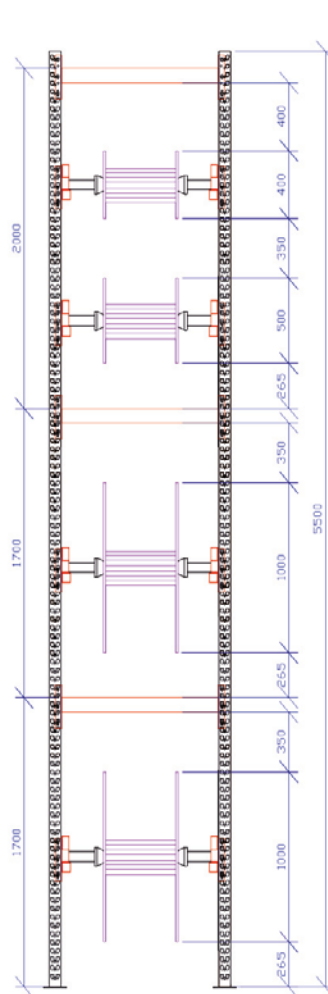

Height
5,500 mm

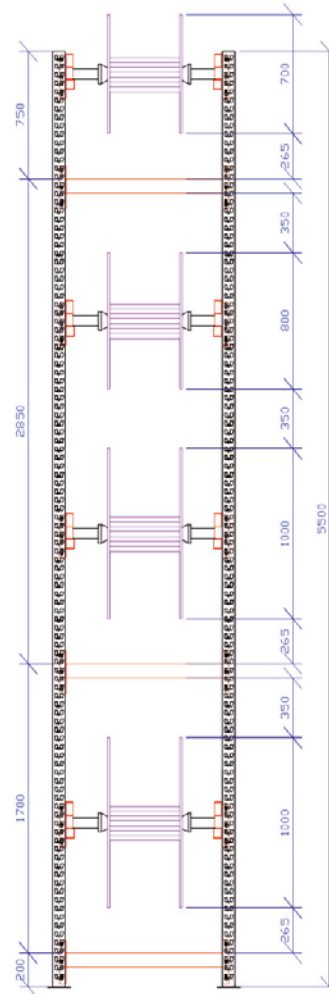

Height
5,500 mm

META MULTIPAL Cable Drum Rack Type 3

Order suggestions A stand suitable for manual processing



- META cable reel racks with A-stands are particularly suitable for clear and attractive storage / presentation in large-scale electrical shops.
- META Cable Drum System is the basis for a clear and space-saving storage of cable drums of a wide variety of designs.
- The screwed shelves can be flexibly adapted to the most diverse requirements.
- Subsequent additions and extensions are easily possible.
- Quick and easy to assemble system accessories.
- The accessories such as tie bars, mounting parts for drum axle, including ground anchors, are completely included. The cable drum axle must be selected separately (see page 9).
- The order proposals include 2 stands for basic section, 1 stand for add-on section
- For transport reasons, the products are delivered disassembled.
- Stand heights from 3,300 to 4,900 mm
Stand depths from 900 and 1,100 mm
Shelf widths of 900, 1,100, 1,300 mm
- Galvanized or plastic coated stand RAL 5010 gentian blue
Diagonal galvanized
Tie bars RAL 2001 red orange
- Intact drums/ flawless cargo are assumed

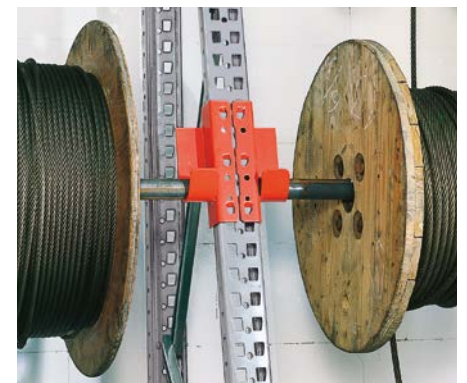

Cable drum racks · incl. Cable drum support **Type 3** without cable drum axle

| Section Height mm | Section Width mm | Section Depth mm | Record Number of Axles | Section Load kg | Galvanized stand | | RAL 5010 gentian blue | |
|----------------------|---------------------|---------------------|---------------------------|--------------------|--------------------------|--------------------------|--------------------------|--------------------------|
| | | | | | Basic Shelf | Extension Shelf | Basic Shelf | Extension Shelf |
| | | | | | Art. No. 402 6212 ... | Art. No. 402 6212 ... | Art. No. 402 6212 ... | Art. No. 402 6212 ... |
| 3,300 | 900 | 900 | 2 | 1,500 | ■ ... 394832 | ■ ... 394665 | ■ ... 144543 | ■ ... 144574 |
| 3,300 | 1,100 | 900 | 2 | 1,500 | ■ ... 394689 | ■ ... 394672 | ■ ... 144550 | ■ ... 144581 |
| 3,300 | 1,300 | 900 | 2 | 1,500 | ■ ... 394696 | ■ ... 394702 | ■ ... 144567 | ■ ... 144598 |
| 4,400 | 900 | 1,100 | 3 | 2,250 | ■ ... 394719 | ■ ... 394740 | ■ ... 144604 | ■ ... 144635 |
| 4,400 | 1,100 | 1,100 | 3 | 2,250 | ■ ... 394726 | ■ ... 394757 | ■ ... 144611 | ■ ... 144642 |
| 4,400 | 1,300 | 1,100 | 3 | 2,250 | ■ ... 394733 | ■ ... 394764 | ■ ... 144628 | ■ ... 144659 |
| 4,900 | 900 | 1,100 | 4 | 3,000 | ■ ... 394771 | ■ ... 394801 | ■ ... 144673 | ■ ... 144703 |
| 4,900 | 1,100 | 1,100 | 4 | 3,000 | ■ ... 394788 | ■ ... 394818 | ■ ... 144680 | ■ ... 144710 |
| 4,900 | 1,300 | 1,100 | 4 | 3,000 | ■ ... 394795 | ■ ... 394825 | ■ ... 144697 | ■ ... 144727 |

■ on request

META MULTIPAL Cable Drum Rack

Range of Accessories



2 only with 7

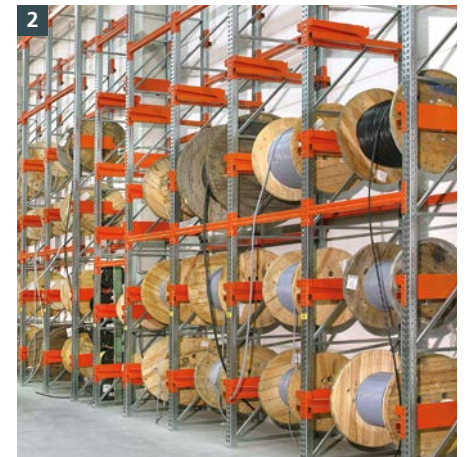
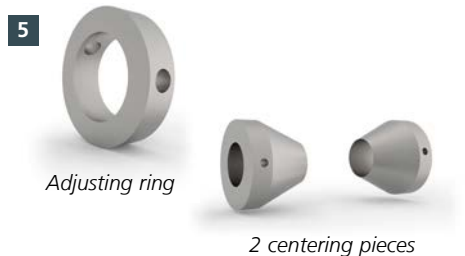

1 2 3 Cable drum support pair

| Description | Art. No. 402 6212 ... |
|--|-----------------------|
| Type 1: permissible load: max. 1,000 kg/pair (for stand depth 1,100) | ■ ... 143010 |
| Type 2: permissible load: max. 1,000 kg/pair (for stand depth 1,100); ONLY with 7 | ■ ... 143041 |
| Type 3: permissible load: 750 kg/pair | ■ ... 144666 |

4 Cable drum axle without centering

| Section Width mm | Diameter 42 mm | Diameter 60 mm |
|---------------------|-----------------------|-----------------------|
| | Art. No. 402 6212 ... | Art. No. 402 6212 ... |
| 900 | ■ ... 142495 | ■ ... 142525 |
| 1100 | ■ ... 142501 | ■ ... 142532 |
| 1300 | ■ ... 142518 | ■ ... 142549 |

5 Adjusting ring / centering pieces

| Description | Diameter 42 mm Art. No. 402 6212 ... | Diameter 60 mm Art. No. 402 6212 ... |
|--|---|---|
| for lateral locking of the cable drum incl. threaded pin for fixing (1 piece) | ■ ... 053784 | ■ ... 053647 |
| Centering pieces (2 pcs.) with hexagonal screw | ■ ... 053654 | ■ ... 053661 |

6 Cable drum axle with centering pieces

| Section Width mm | Diameter 42 mm | Diameter 60 mm |
|---------------------|-----------------------|-----------------------|
| | Art. No. 402 6212 ... | Art. No. 402 6212 ... |
| 900 | ■ ... 142716 | ■ ... 142747 |
| 1100 | ■ ... 142723 | ■ ... 142754 |
| 1300 | ■ ... 142730 | ■ ... 142761 |

7 Cable drum axle with centering pieces and plastic rollers

Use with support type 2

| Section Width mm | Diameter 42 mm | Diameter 60 mm |
|---------------------|-----------------------|-----------------------|
| | Art. No. 402 6212 ... | Art. No. 402 6212 ... |
| 900 | ■ ... 142778 | ■ ... 142808 |
| 1100 | ■ ... 142785 | ■ ... 142815 |
| 1300 | ■ ... 142792 | ■ ... 142822 |



If the core bore diameter of the cable drum is ≥ 80 mm, the axle with the 60 mm diameter should be used in any case, regardless of the weight and width of the cable drum.

META MULTIPAL Cable Drum Rack

Information Matrix

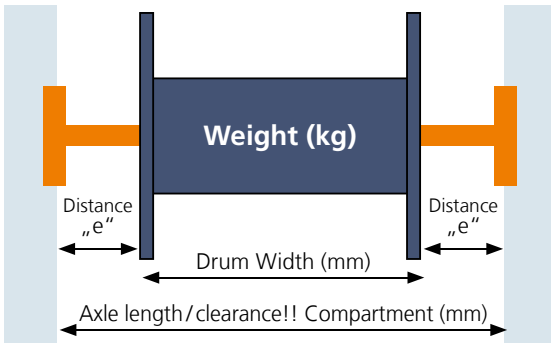
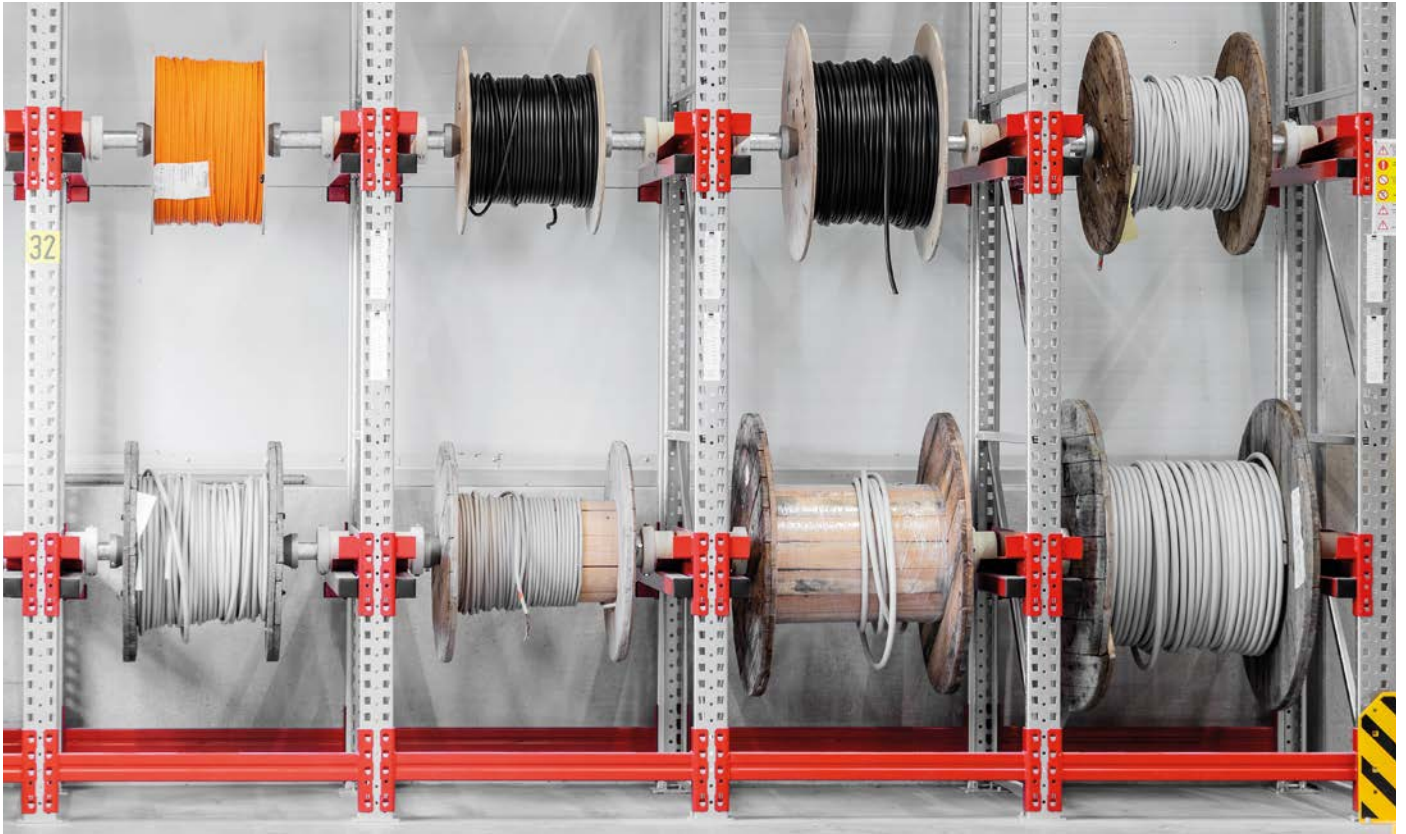

$e \geq 200 \text{ mm}$

Distance between inner edge of stand/outer edge of drum

Cable drum load specifications of the axes

for Cable Drum Support **Type 1** and **Type 2** · for Cable Drum Support **Type 3** max. 750 kg

| clearance shelf width: 900 mm | | Stand depth: 1,100 mm | |
|-------------------------------|------------------------|-----------------------|--|
| Drum Width mm | max. Drum weight in kg | | |
| | Axle Ro 42,4 x 4 | Axle Ro 60,3 x 5 | |
| 500 | 537 | 1,000 | |
| 450 | 477 | 1,000 | |
| 400 | 429 | 1,000 | |
| 350 | 390 | 1,000 | |
| 300 | 358 | 937 | |
| 250 | 330 | 865 | |
| 200 | 307 | 803 | |
| 150 | 286 | 749 | |
| 100 | 268 | 703 | |

| clearance shelf width: 1,100 mm | | Stand depth: 1,100 mm | |
|---------------------------------|------------------------|-----------------------|--|
| Drum Width mm | max. Drum weight in kg | | |
| | Axle Ro 42,4 x 4 | Axle Ro 60,3 x 5 | |
| 700 | 537 | 1,000 | |
| 650 | 477 | 1,000 | |
| 600 | 429 | 1,000 | |
| 550 | 390 | 1,000 | |
| 500 | 358 | 937 | |
| 450 | 330 | 865 | |
| 400 | 307 | 803 | |
| 350 | 286 | 749 | |
| 300 | 268 | 703 | |

| clearance shelf width: 1,300 mm | | Stand depth: 1,100 mm | |
|---------------------------------|------------------------|-----------------------|--|
| Drum Width mm | max. Drum weight in kg | | |
| | Axle Ro 42,4 x 4 | Axle Ro 60,3 x 5 | |
| 900 | 537 | 1,000 | |
| 850 | 477 | 1,000 | |
| 800 | 429 | 1,000 | |
| 750 | 390 | 1,000 | |
| 700 | 358 | 937 | |
| 650 | 330 | 865 | |
| 600 | 307 | 803 | |
| 550 | 286 | 749 | |
| 500 | 268 | 703 | |